

# BALL SLIDE ASSEMBLIES

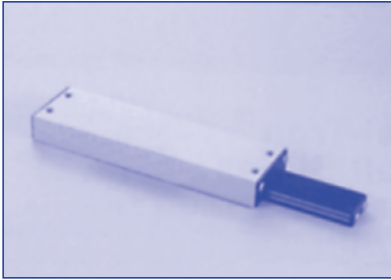

**New**

See page 28M for specifications

\* Travel is 1/2 distance from center in either direction

Model	Travel *	Load Capacity LB	Weight OZ	Length A	Height B	Width C	Carriage Hole Spacing		Base Dimensions		
							D	E	Height F	Width G	Hole Spacing H
MGX-A1-1	.50	1.5	.10	.75	.23	.38	.375	.156	.135	.156	.375
MGX-A1-2	1.00	1.5	.15	1.25	.23	.38	.875	.156	.135	.156	.875
MGX-A1-3	1.50	1.5	.25	1.75	.23	.38	1.375	.156	.135	.156	1.375
MGX-A1-4	.50	4	.30	1.06	.32	.56	.625	.218	.187	.250	.750
MGX-A1-5	1.00	8	.50	2.06	.32	.56	1.625	.218	.187	.250	1.375
MGX-A1-6	2.00	12	.80	3.06	.32	.56	2.625	.218	.187	.250	2.375
MGX-A1-7	3.00	14	1.1	4.06	.32	.56	3.625	.218	.187	.250	3.375
MGX-A1-8	4.00	16	1.2	5.06	.32	.56	4.625	.218	.187	.250	3.500
MGX-A1-9	5.00	18	1.5	6.06	.32	.56	5.625	.218	.187	.250	4.500
MGX-A1-10	.50	8	.40	1.06	.41	.75	.625	.375	.250	.375	.750
MGX-A1-11	1.00	10	.90	2.06	.41	.75	1.625	.375	.250	.375	1.375
MGX-A1-12	2.00	12	1.3	3.06	.41	.75	2.625	.375	.250	.375	2.375
MGX-A1-13	3.00	14	1.7	4.06	.41	.75	3.625	.375	.250	.375	3.375
MGX-A1-14	4.00	16	2.1	5.06	.41	.75	4.625	.375	.250	.375	3.500
MGX-A1-15	5.00	18	2.5	6.06	.41	.75	5.625	.375	.250	.375	4.500
MGX-A1-16	.50	10	1.2	1.56	.50	1.00	1.250	.437	.250	.500	1.250
MGX-A1-17	1.00	12	1.7	2.56	.50	1.00	2.250	.437	.250	.500	2.250
MGX-A1-18	1.50	13	1.9	3.06	.50	1.00	2.750	.437	.250	.500	2.750
MGX-A1-19	2.00	15	2.2	3.56	.50	1.00	3.250	.437	.250	.500	3.250
MGX-A1-20	3.00	18	5.0	4.56	.50	1.00	4.250	.437	.250	.500	4.250

MGX SERIES	A1-1 to -3	A1-4 to -9	A1-10 to -15	A1-16 to -20	B1-1 to -5	B1-6 to -10	B1-11 to -15	B1-16 to -20
Carriage 4 Holes (I)	2-56 UNC- 2B Thread	2-56 UNC- 2B Thread	4-40 UNC- 2B Thread	6-32 UNC- 2B Thread	6-32 UNC- 2B Thread	6-32 UNC- 2B Thread	6-32 UNC- 2B Thread	10-32 UNF- 2B Thread
Base Hole d	2-56 Unc	.101	.125	.125	.157	.157	.157	.204
Base Hole D1	----	.144	.198	.198	.244	.244	.244	.328
Base Hole h	----	.100	.125	.125	.150	.150	.150	.205
Counter Bore Screw Size	N/A	#2	#4	#4	#6	#6	#6	#10

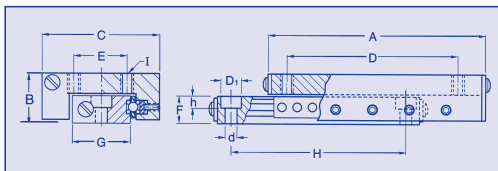

# BALL SLIDE ASSEMBLIES

continued from 27M

**New**

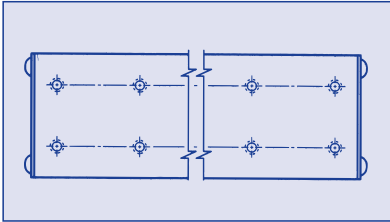

**SPECIFICATIONS:**  
**Straight line accuracy**  
**Positional repeatability**  
**Coefficient of friction**  
**Construction**

0.0005"/inch of travel  
 0.0002"  
 0.003 typical  
 Aluminum carriage and  
 base, hardened steel  
 shafts and balls, mild  
 steel end caps  
 Clear anodized carriage  
 and black anodized base.  
 Other finishes on request

**Finish**

For metric sizes please call.  
 See page 27M for detailed drawing

\* Travel is 1/2 distance from center in either direction

Model	Travel *	Load Capacity LB	Weight OZ	Length A	Height B	Width C	Carriage Hole Spacing		Base Dimensions		
							D	E	Height F	Width G	Hole Spacing H
MGX-B1-1	.75	15	1.3	1.56	.53	1.06	1.250	.437	.312	.500	1.125
MGX-B1-2	1.50	18	2.3	2.56	.53	1.06	2.250	.437	.312	.500	2.125
MGX-B1-3	2.00	20	3.0	3.56	.53	1.06	3.250	.437	.312	.500	3.125
MGX-B1-4	3.00	25	5.2	4.56	.53	1.06	4.000	.437	.312	.500	3.250
MGX-B1-5	4.00	30	6.0	6.00	.53	1.06	5.500	.437	.312	.500	4.000
MGX-B1-6	1.00	15	2.9	2.00	.62	1.50	1.375	.625	.340	.750	1.500
MGX-B1-7	2.00	20	4.3	3.00	.62	1.50	2.375	.625	.340	.750	2.500
MGX-B1-8	3.00	25	6.0	4.00	.62	1.50	3.375	.625	.340	.750	3.500
MGX-B1-9	3.50	30	6.7	5.00	.62	1.50	4.375	.625	.340	.750	3.500
MGX-B1-10	4.00	35	8.2	6.00	.62	1.50	5.375	.625	.340	.750	4.000
MGX-B1-11	1.00	20	4.0	2.00	.75	1.75	1.375	.875	.400	.875	1.625
MGX-B1-12	1.50	30	6.0	2.75	.75	1.75	2.125	.875	.400	.875	2.250
MGX-B1-13	2.00	42	6.5	3.25	.75	1.75	2.625	.875	.400	.875	2.750
MGX-B1-14	3.00	52	8.0	4.00	.75	1.75	3.375	.875	.400	.875	3.500
MGX-B1-15	4.00	60	11.8	6.00	.75	1.75	5.500	.875	.400	.875	4.000
MGX-B1-16	1.00	30	10.0	2.62	1.00	2.62	2.125	1.250	.625	1.500	2.125
MGX-B1-17	1.50	35	10.0	2.62	1.00	2.62	1.625	1.250	.625	1.500	1.875
MGX-B1-18	2.00	62	15.0	4.00	1.00	2.62	3.000	1.250	.625	1.500	3.375
MGX-B1-19	3.00	88	20.8	5.00	1.00	2.62	4.000	1.250	.625	1.500	4.375
MGX-B1-20	4.00	118	27.2	6.00	1.00	2.62	5.000	1.250	.625	1.500	5.375